

Garden Highlights, November 2022



Photos: Left: Giant Spear Lily
Doryanthes palmeri.

Right: Forest Bells *Mackaya bella*.



The **Giant Spear Lily** *Doryanthes palmeri* is in bloom. It is native to Northern NSW and the Queensland coast. Each giant rosette of leaves flowers once in its lifetime. After flowering, the plant produces new, small rosettes. We are lucky to have several plants growing here so we don't have to wait 8 years before the young rosettes reach maturity and flower again.

Forest Bells *Mackaya bella*, is from the summer rainfall, evergreen forests of southern Africa. It grows well in deep shade. If you look closely at the leaves, you may see little pimples under the leaves, where the side veins join the central vein. These are made by the plant to house tiny animals that help the plant by keeping the leaf free of pests.

What's On in November 2022

Guided Walk: 'Green Spine'

Sunday 13 November, **CANCELLED**.

Friends Nursery Plant Sale:

Saturday 19 November 10 am - 4 pm.

Discovery Table:

Sunday 20 November 1 - 3 pm.

Free Guided Walks:

Wednesdays 11 am, Sundays 2 pm.

Friends Nursery open:

Wednesdays 9:30 am - 12:30 pm.

Friends Christmas Picnic,

Friday 2 December, 5:30 pm.

Friends and their guests only.

Birds of the Botanic Gardens and

Eastern Park: See Friends website:

Events / 2022 Program / Links from Craig Morley's Winter Lecture

The Conservatory is open:

10 am - 4 pm every day.

(For more details about What's On: Friends website or phone.)

Bookings: www.friendsgbg.org.au

Phone: 5222 6053

www.geelongaustralia.com.au/gbg/



Geelong Botanic Gardens map

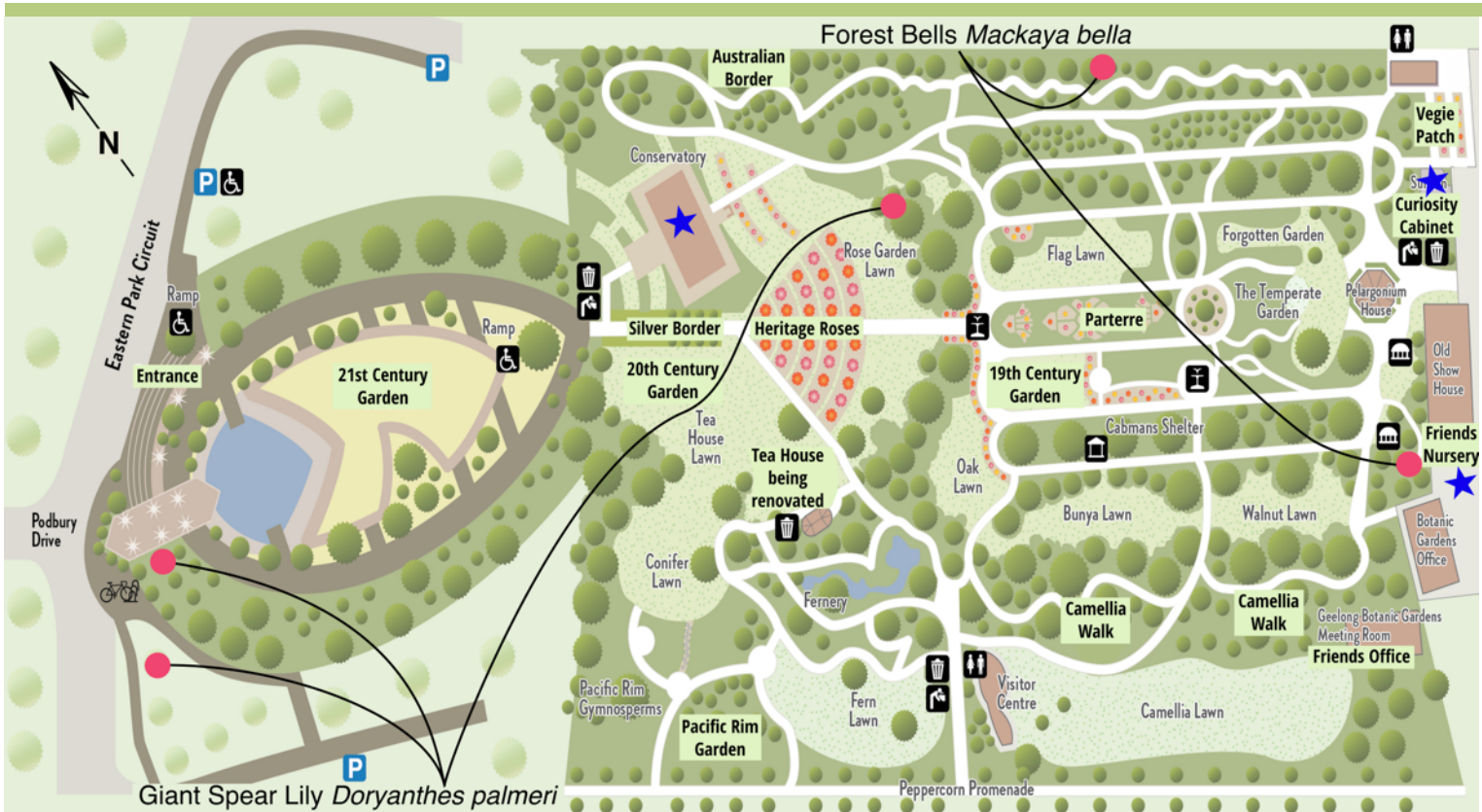

This information was developed by the Volunteer Guides
 Friends of Geelong Botanic Gardens.
www.friendsgbg.org.au
www.geelongaustralia.com.au/gbg/

