

Garden Highlights, October 2022



The **Emu bush** genus *Eremophila*, has 271 species. All of them are native only to Australia. These shrubs and small trees grow in arid areas, where they are pollinated by birds and insects. Those with red, orange, yellow or green flowers point slightly downwards and have long projecting stamens and stigma that suit birds. The blue, purple and white ones have protruding lower lips providing a landing area for insects. You will see a variety of these colours and flower shapes in Australian beds (see map over page).



Over page: Map showing plant locations

What's On in October 2022

Guided Walk: 'Australian Plants in Flower' Sunday 9 October 2 pm, gold coin donation.

'Through the Garden Gates' self-drive tour of five gardens. Monday 10 October, 10:00 am - 4:00 pm. Book: FGBG members \$30, Non-members \$40.

Discovery Table: Sunday 16 October 1 - 3 pm.

Free Guided Walks: Wednesdays 11 am, Sundays 2 pm.

Friends Nursery open: Wednesdays 9:30 am - 12:30 pm.

The Conservatory is open: 10 am - 4 pm every day.

(For more details about What's On: Friends website or phone.)

Bookings: www.friendsgbg.org.au
Phone: 5222 6053
www.geelongaustralia.com.au/gbg/



Geelong Botanic Gardens map

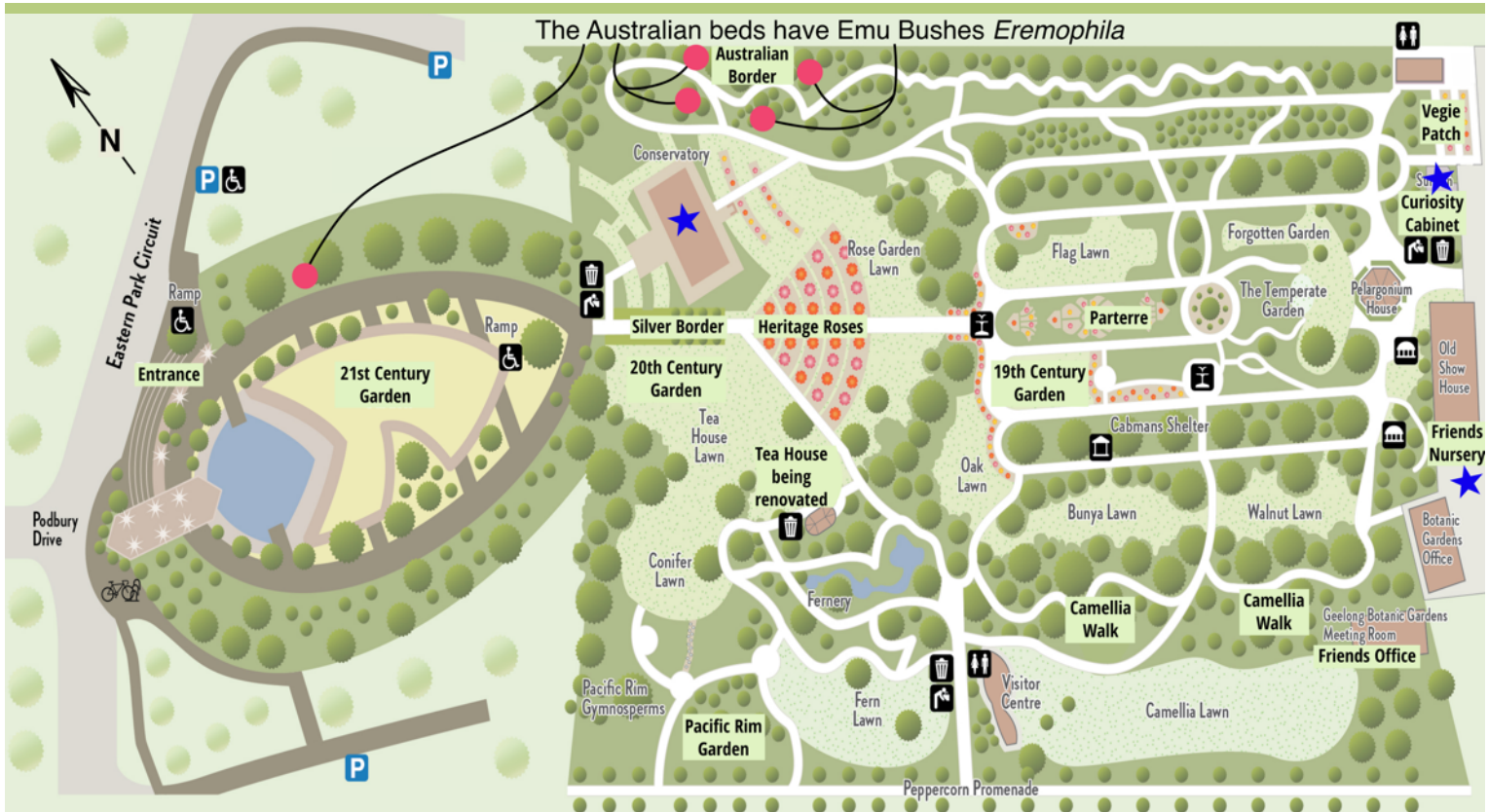

The top image over the page is:
Narrow-leaved Emu Bush
Eremophila alternifolia.

This information was developed by the Volunteer Guides
Friends of Geelong Botanic Gardens.
www.friendsgbg.org.au
www.geelongaustralia.com.au/gbg/

