

Garden Highlights, August 2022



Canary Island Bell-flower *Canarina canariensis* only grows wild (ie. is endemic) in the cloud forests of the Canary Islands. This Bell Flower disappears into its underground tuberous roots for 6 months of hot, dry weather by dropping its leaves and stems. It then sprouts and flowers in winter and early spring.

It looks similar to its cousins the Blue Bell-flowers *Campanula*, but has orange flowers. (Bell-flowers have broad leaves unlike the unrelated Blue Bells *Hyacinthoides* and *Scilla* that have long strap-like leaves.)

Like most isolated islands, the Canary Island archipelago has many endemic plants - 700 species across its islands.

The Canary Island Bell-flower shares the bed next to the entrance to the twentieth-century garden with plants from various islands, including Phillip Island (5 km south of Norfolk Island), Lord Howe Island and others from the Canary islands.

Over page: Map showing plant locations

What's On in August 2022

Winter Lecture Program via Zoom, weekly on Thursdays, continues in August, 11 am - 12 pm.
Book for the series.

Movie Night "Dare to be Wild"
Friday 12 August, 5:30 - 8:00 pm
FGBG Members \$20.00,
Non-members \$25.00

Guided Walk: 'Wattle It Be'
Sunday 14 August 2 pm,
gold coin donation.

Discovery Table:
Sunday 21 August 1 - 3 pm.

Gwen's winter cooking demonstration, Thursday 8 September 10 am - 2 pm,
FGBG Members \$20.00,
Non-members \$25.00

Free Guided Walks:
Wednesdays 11 am,
Sundays 2 pm.

Friends Nursery open:
Wednesdays
9:30 am - 12:30 pm.

The Conservatory is open:
10 am - 4 pm every day.

The **Tea House** is closed for renovation. It is planned to re-open by summer.

The Curiosity Cabinet:
displays plants from arid areas.
(For more details about What's On: Friends website or phone.)

Bookings: www.friendsgbg.org.au
Phone: 5222 6053
www.geelongaustralia.com.au/gbg/



Geelong Botanic Gardens map

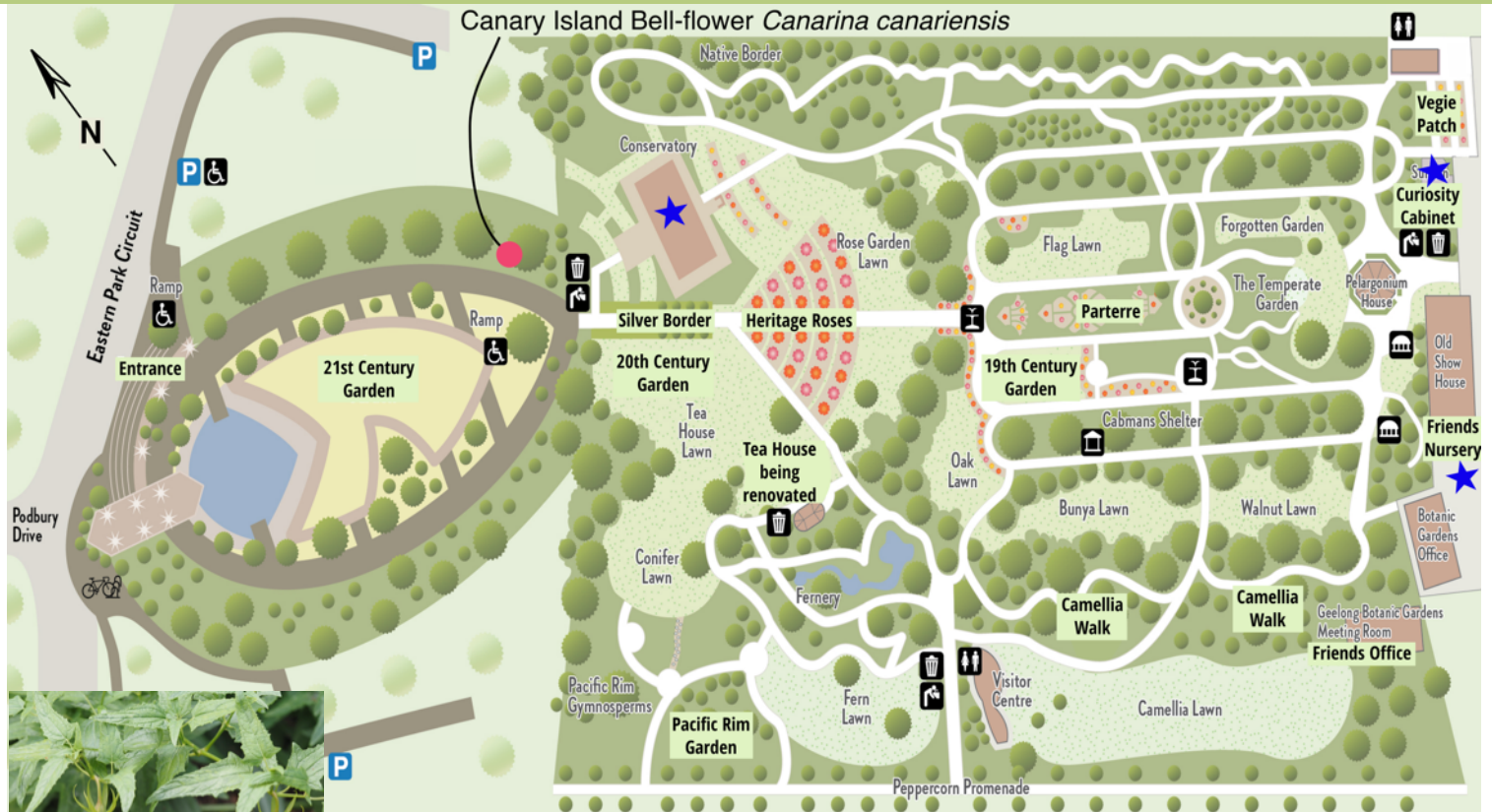

Plant: Canary Island Bell-flower
Canarina canariensis

This information was developed by the Volunteer Guides
Friends of Geelong Botanic Gardens.

www.friendsgbg.org.au
www.geelongaustralia.com.au/gbg/

