

# Garden Highlights, July 2022



On a cold winter day, visit the **Conservatory** to warm up. Inside you will find a display of tropical plants. The display is changed frequently as plants come into flower or are attractive in other ways. You may be lucky enough to see the **Black Bat Flower *Tacca chantrieri***, shown in the photos above. Or you may see its cousin the **White Bat Flower *Tacca integrifolia***. The big black flaps are modified leaves (called bracts), as are the long whiskers. It has many smaller flowers that open successively. The petals form a cup (photo at the right).

The 17 species of *Tacca* are all in the Yam family Dioscoreaceae. Polynesian people grow another species, Polynesian Arrowroot *Tacca leontopetaloides*, to eat its starch-rich yams.

A South African yam plant growing in the **Curiosity Cabinet** is the **Elephant's Foot *Dioscorea Elephantipes***. Its tuber is now too large to fit through the door of the cabinet. The Khoisan people used to bake these yams to eat. The plant loses its leaves during the dry summer. Then, in the winter rains, it grows vigorously. You can see its many leaves under the glass of the Curiosity Cabinet.

Over page: Map showing plant locations

## What's On in July 2022

**Winter Lecture Program** via Zoom, weekly on Thursdays, continues in July and August, 11:00am - 12:00 pm. Book for the series.

### Friends Plant Sale:

Saturday 16 July 10 am - 4 pm

Guided Walk: **'Eastern Park Walk'**

Sunday 17 July 2:00 pm, gold coin donation.

### Discovery Table:

Sunday 17 July 1:00 - 3:00 pm.

### Free Guided Walks:

Wednesdays 11 am, Sundays 2 pm.

### Friends Nursery open:

Wednesdays 9:30 am - 12:30 pm.

### The Conservatory is open:

10 am - 4 pm every day.

The **Tea House** is closed for renovation.

It is planned to re-open by summer.

### The Curiosity Cabinet:

displays plants from arid areas.

(For more details about What's On: Friends website or phone.)

Bookings: [www.friendsgbg.org.au](http://www.friendsgbg.org.au)

Phone: 5222 6053

[www.geelongaustralia.com.au/gbg/](http://www.geelongaustralia.com.au/gbg/)



# Geelong Botanic Gardens map

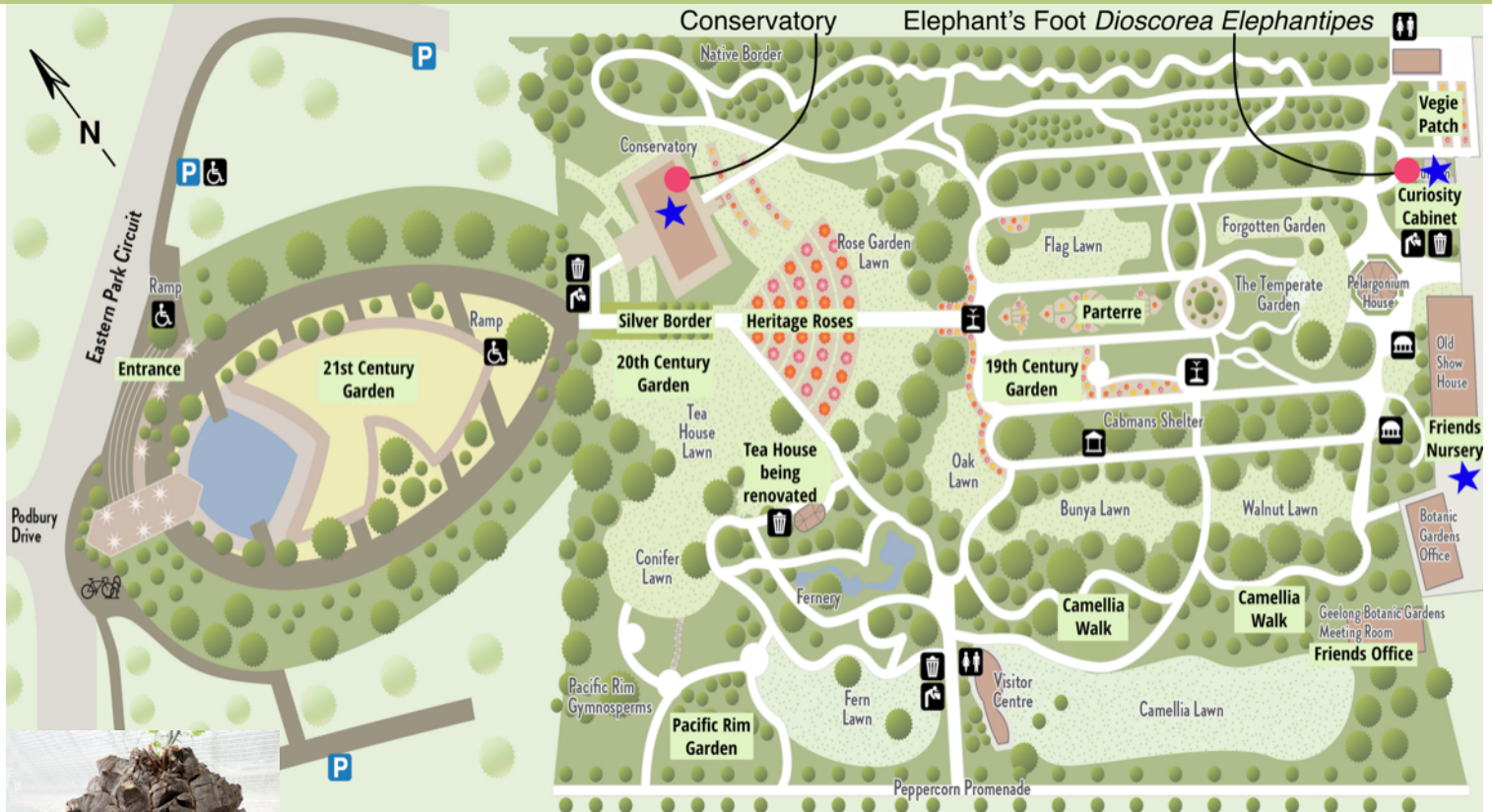

Yam of Elephant's Foot  
*Dioscorea Elephantipes*

This information was developed by the Volunteer Guides  
Friends of Geelong Botanic Gardens.  
[www.friendsgbg.org.au](http://www.friendsgbg.org.au)  
[www.geelongaustralia.com.au/gbg/](http://www.geelongaustralia.com.au/gbg/)

