

Garden Highlights, May 2022



The **Rice Paper Plant *Tetrapanax papyrifer*** flowers at a time when there are fewer other flowers. As a result, its nectar is favoured by many insects. This plant originally only grew wild in Taiwan. It was so wide-spread in places, that it grew as a low forest. Although barely a tree, everything else about this plant is large: its huge leaves and its bunches of numerous, small, white flowers.

Sheets of delicate, paper were made from the pith in the trunk and thick branches. This product was not made from rice, although another form of paper was made from rice hulls. And, it is strictly not paper as it has a different composition and structure from paper. This pith paper was used for paintings of Chinese life and for making paper flowers. These works were very popular in Europe in the 19th century. Off-cuts left after slicing pith into paper sheets were used as a medicine.

Over page: Map showing plant locations

What's On in May 2022

Discovery Table:

Sunday 15 May 1 - 3 pm.

Guided Walk: 'Changing Planet: Plant Adaption' Sunday 29 May 2 pm, gold coin donation.

Free Guided Walks:

Wednesdays 11 am, Sundays 2 pm.

Friends Nursery open:

Wednesdays 9:30 am - 12:30 pm.

The Conservatory is open:

10 am - 4 pm every day.

The Curiosity Cabinet:

displays plants from arid areas.

The Tea House is open every day

(Bookings for groups, etc.
phone 0413 706 535).

(For more details about What's On:
Friends website or phone.)

Bookings: www.friendsgbg.org.au

Phone: 5222 6053

www.geelongaustralia.com.au/gbg/



Geelong Botanic Gardens map

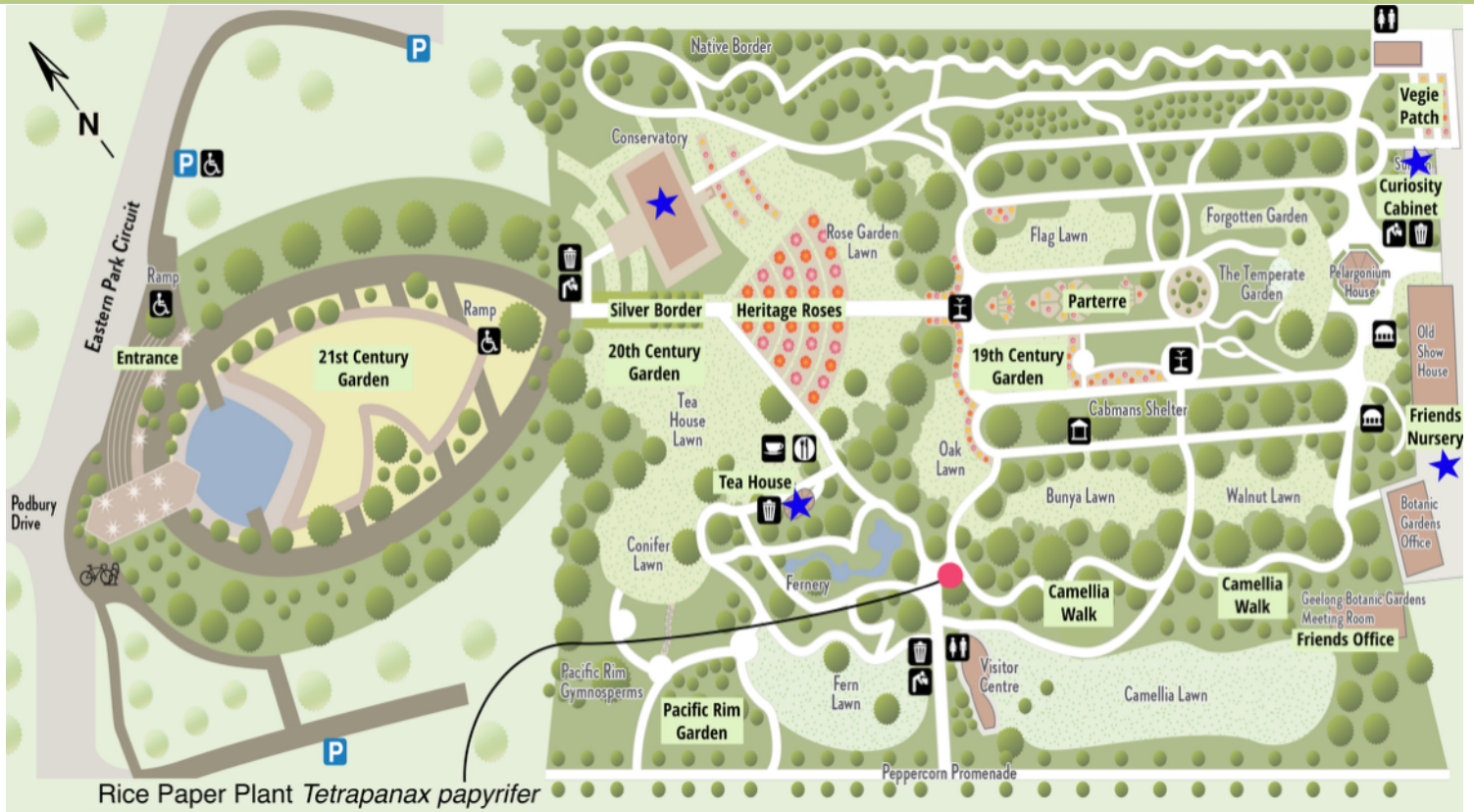

www.friendsgbg.org.au
www.geelongaustralia.com.au/gbg/

This information was developed by the Volunteer Guides
 Friends of Geelong Botanic Gardens.

