

Garden Highlights, October 2021



One of the many plants flowering in the Shrubbery is the **Blue Mist Flower** *Bartlettina sordida*. This shrub comes from high altitude, misty, cloud forests in Mexico.

These flowers have a misty appearance arising from the mass of light purple styles. Like all other daisies, these 'flowers' are composed of many florets. Each floret is actually a tiny flower. The spiky appearance of each flower is created by the female parts of each floret, called the style. The long styles that project high above each tiny flower receive pollen. This leads to a seed being formed. Like most daisies each seed is spread on the wind by a little 'parachute'.

The **Conservatory** is open:
Weekdays 10 am - 4 pm.

The **Tea House** is open every day (Bookings for groups, etc. phone 0413 706 535).

Over page: Map showing plant locations

What's On in October 2021

Covid restrictions: Some activities are cancelled.

A **virtual walk through the Gardens** will be available after 8 October. See website.

National Seniors Month, October, the Friends have a limited number of **free TeaHouse vouchers** for morning tea.

Themed guided walk: **'Chinese plants in our garden'**, Sunday 10 October 2:00 pm, Gold coin donation.

Through the Garden Gates, visit four gardens: Monday 8 November 10:00 am.

Free Guided Walks:

Wednesdays 11:00 am, Sundays 2:00 pm.

Friends Nursery open:

Wednesdays 9:30 am - 12:30 pm.

(For **details about What's On:** Friends website or phone.)

Bookings: www.friendsgbg.org.au

Phone: 5222 6053

www.geelongaustralia.com.au/gbg/



Geelong Botanic Gardens map

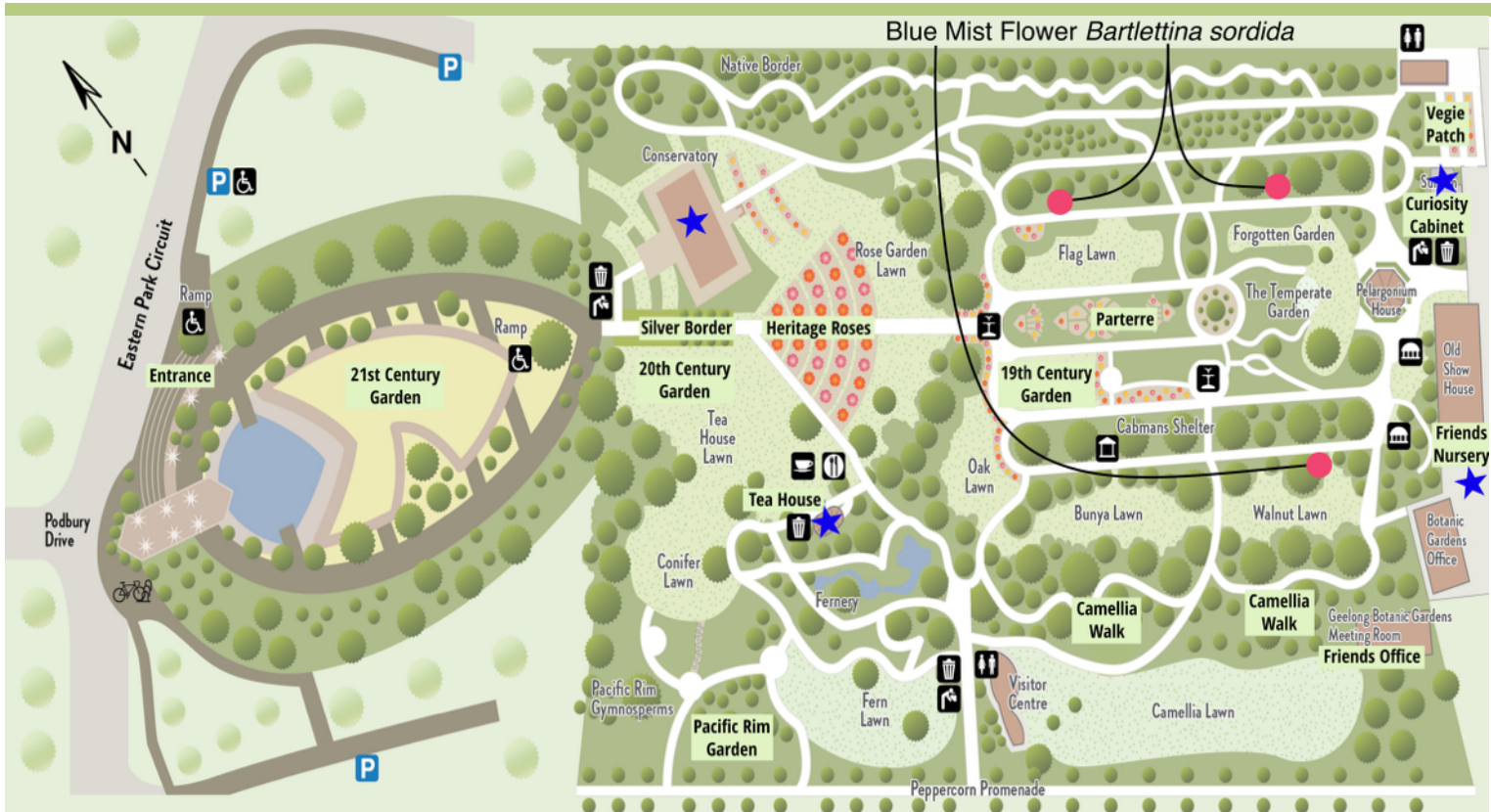

www.friendsgbg.org.au
www.geelongaustralia.com.au/gbg/

This information was developed by the Volunteer Guides
 Friends of Geelong Botanic Gardens.

